

Planches des propositions d'orientations d'aménagements

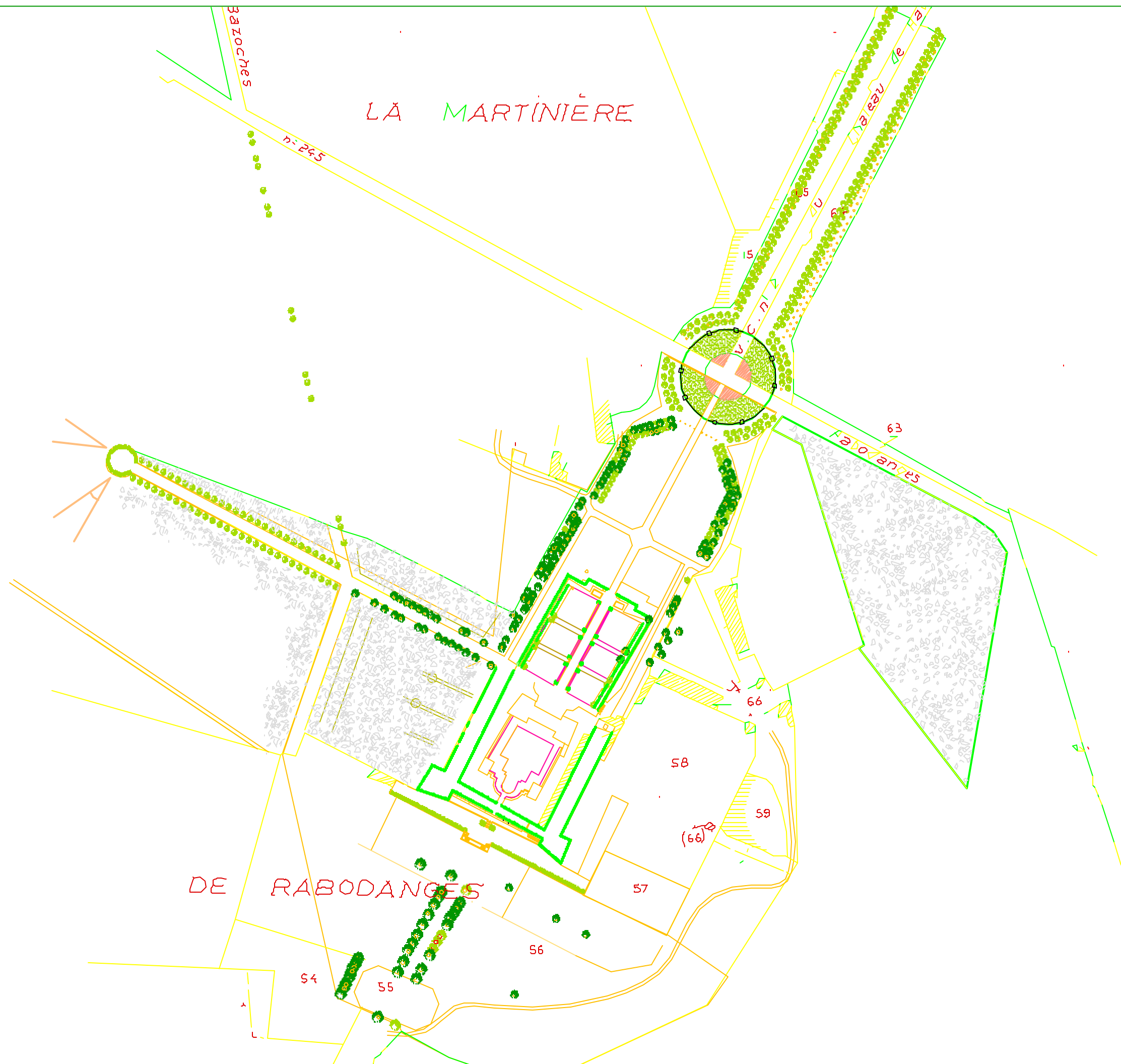

LA MARTINIÈRE

DE RABODANGES

LOCALISATION DES PROPOSITIONS D'ORIENTATIONS D'AMENAGEMENTS

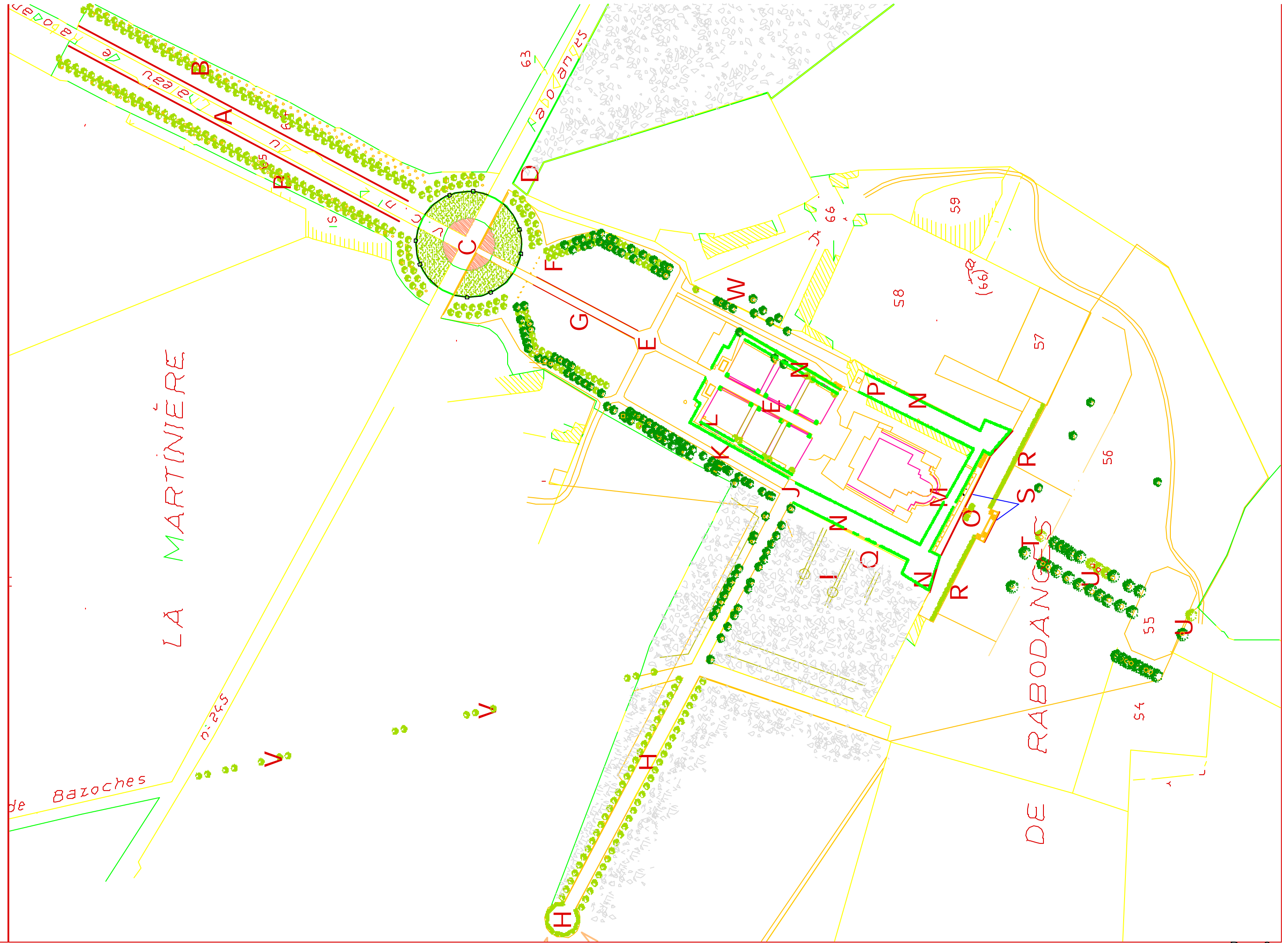

VIERE

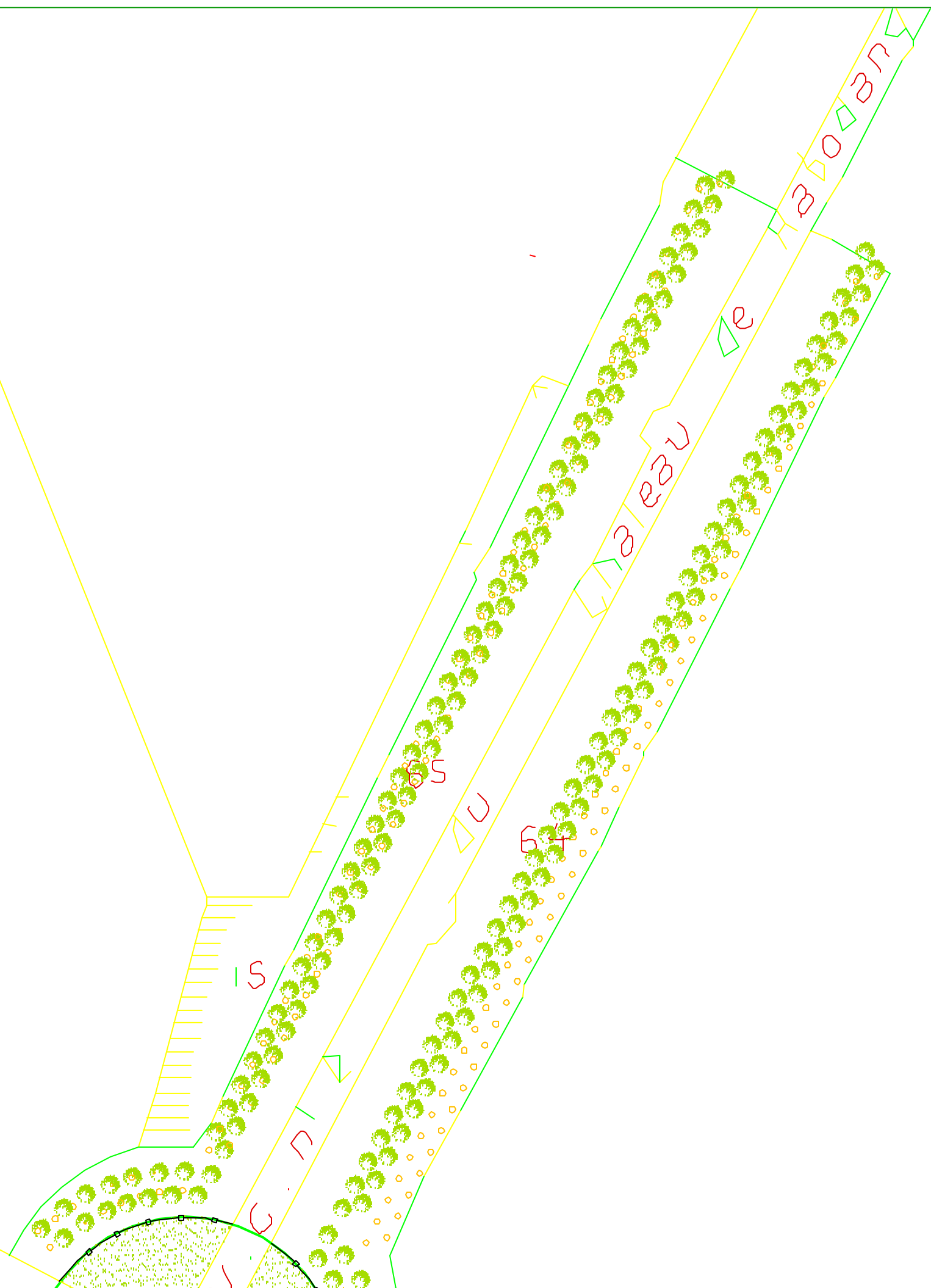

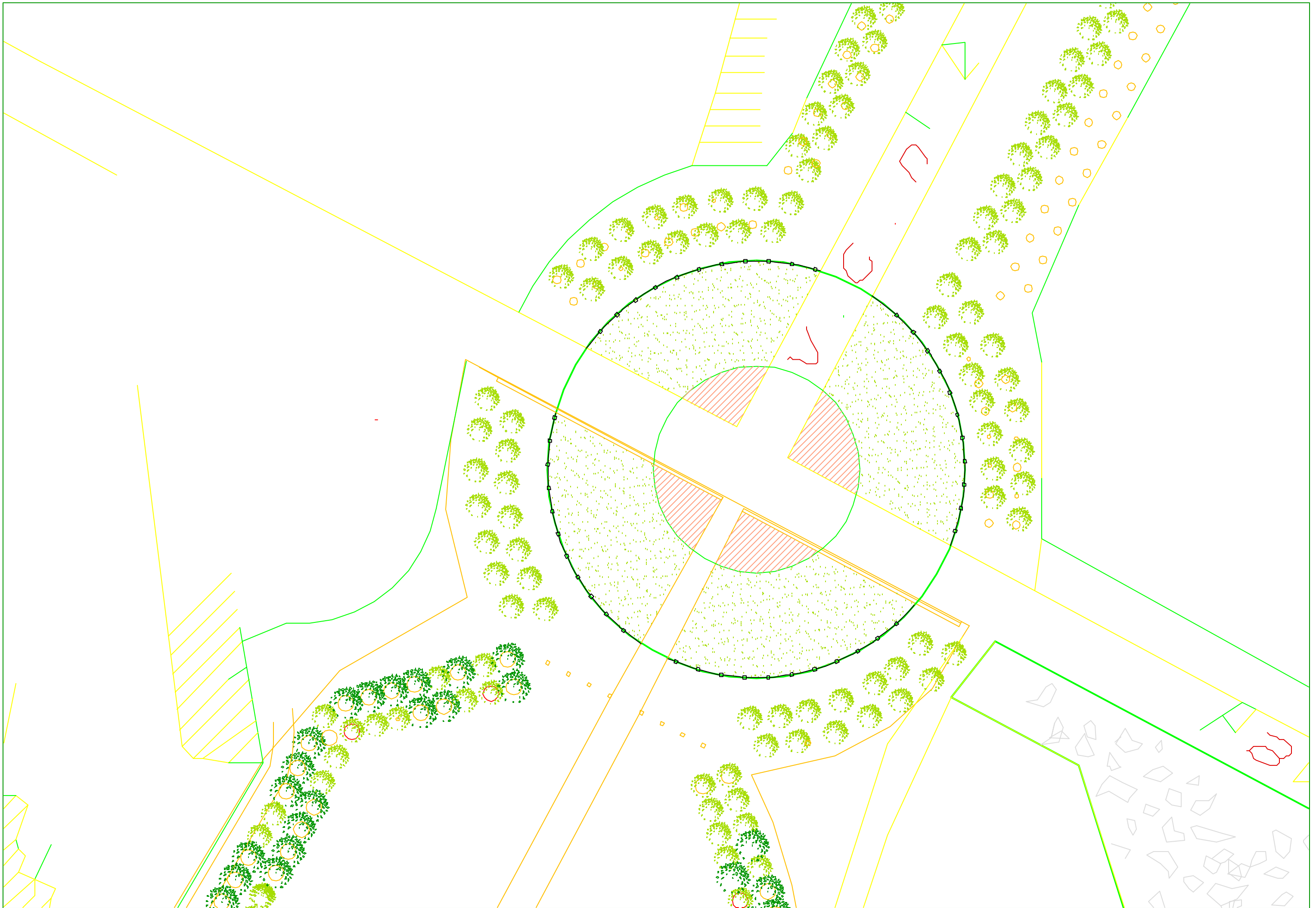

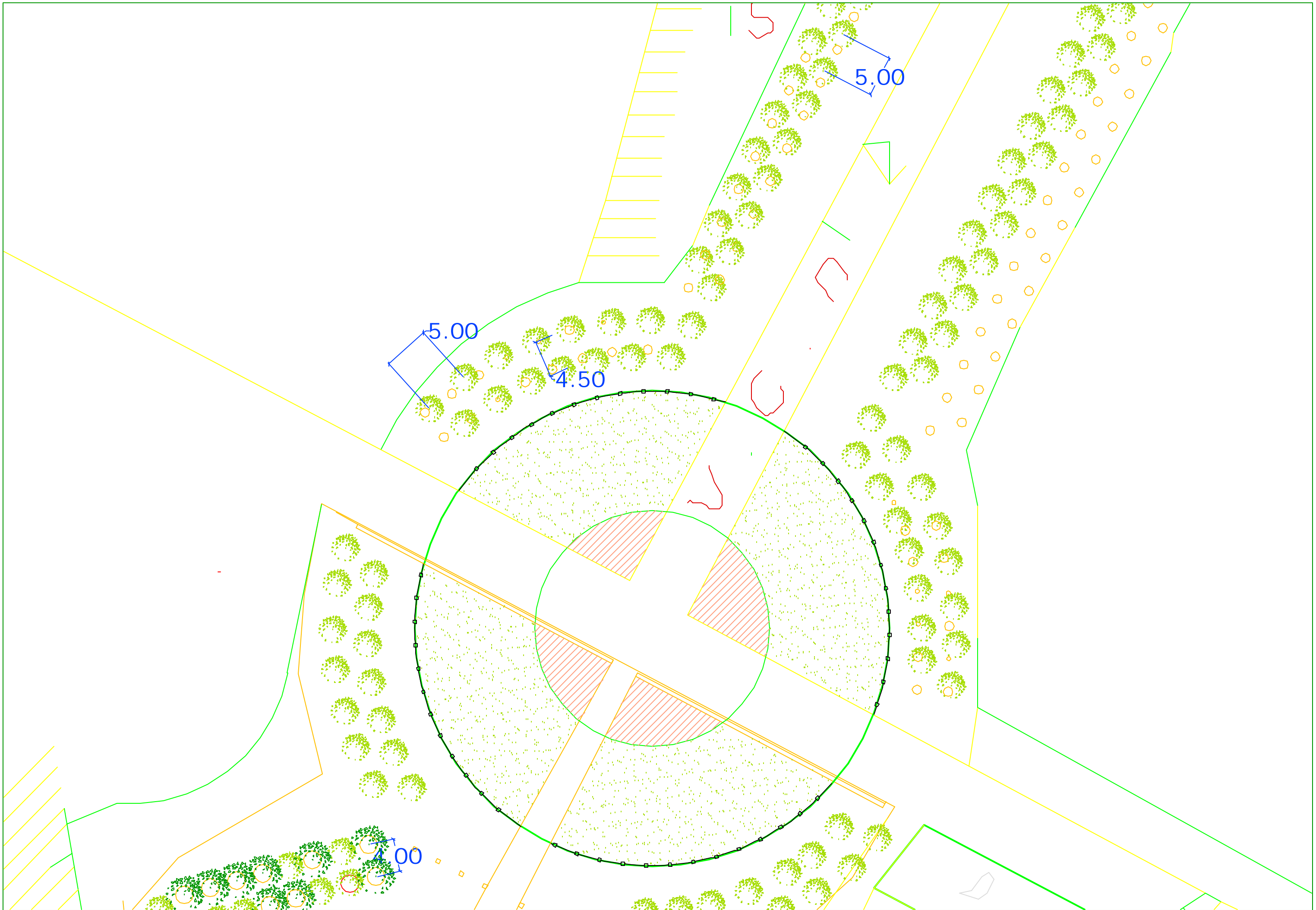

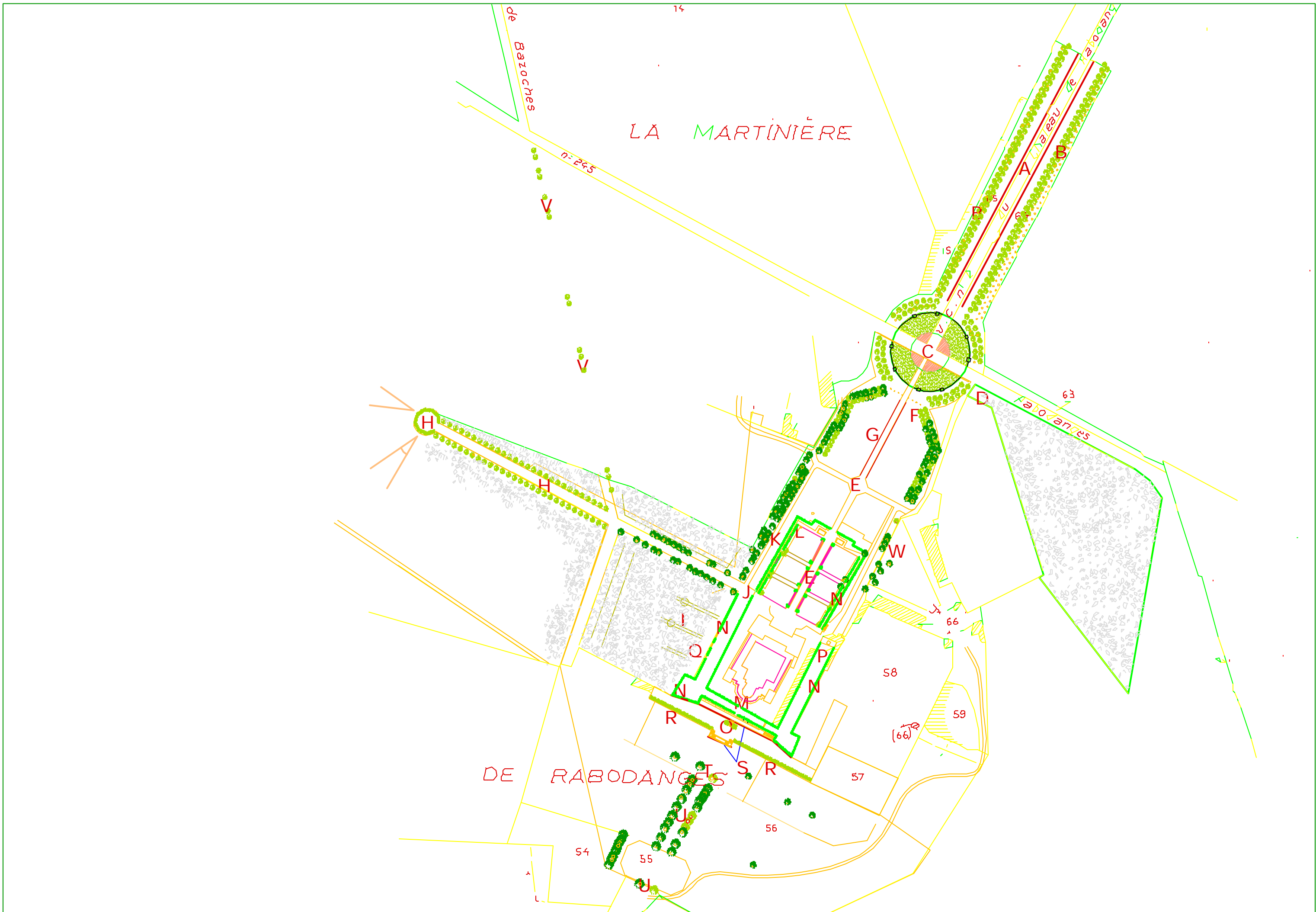

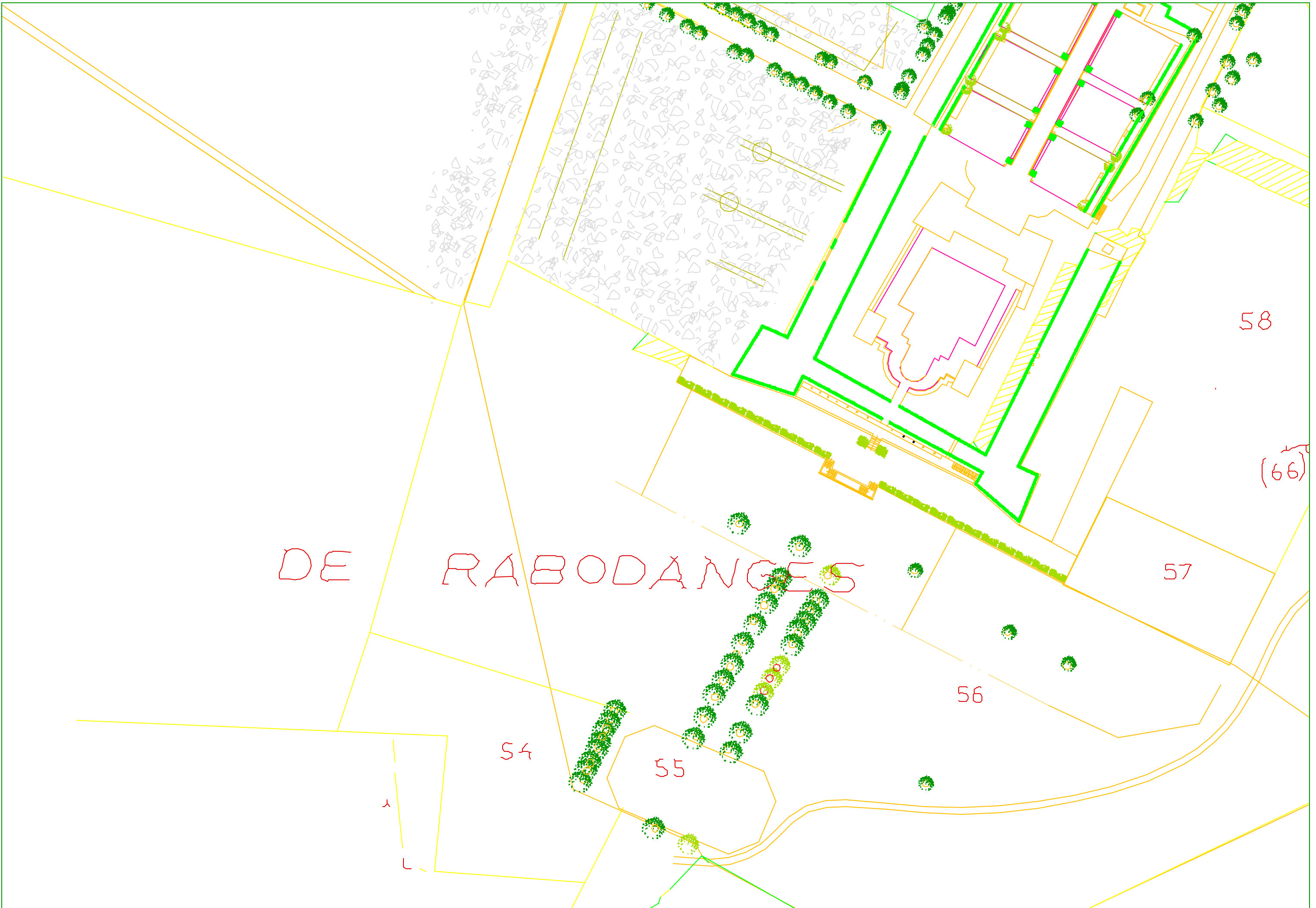

DE RABODANGES

54

55

56

57

58

(66)

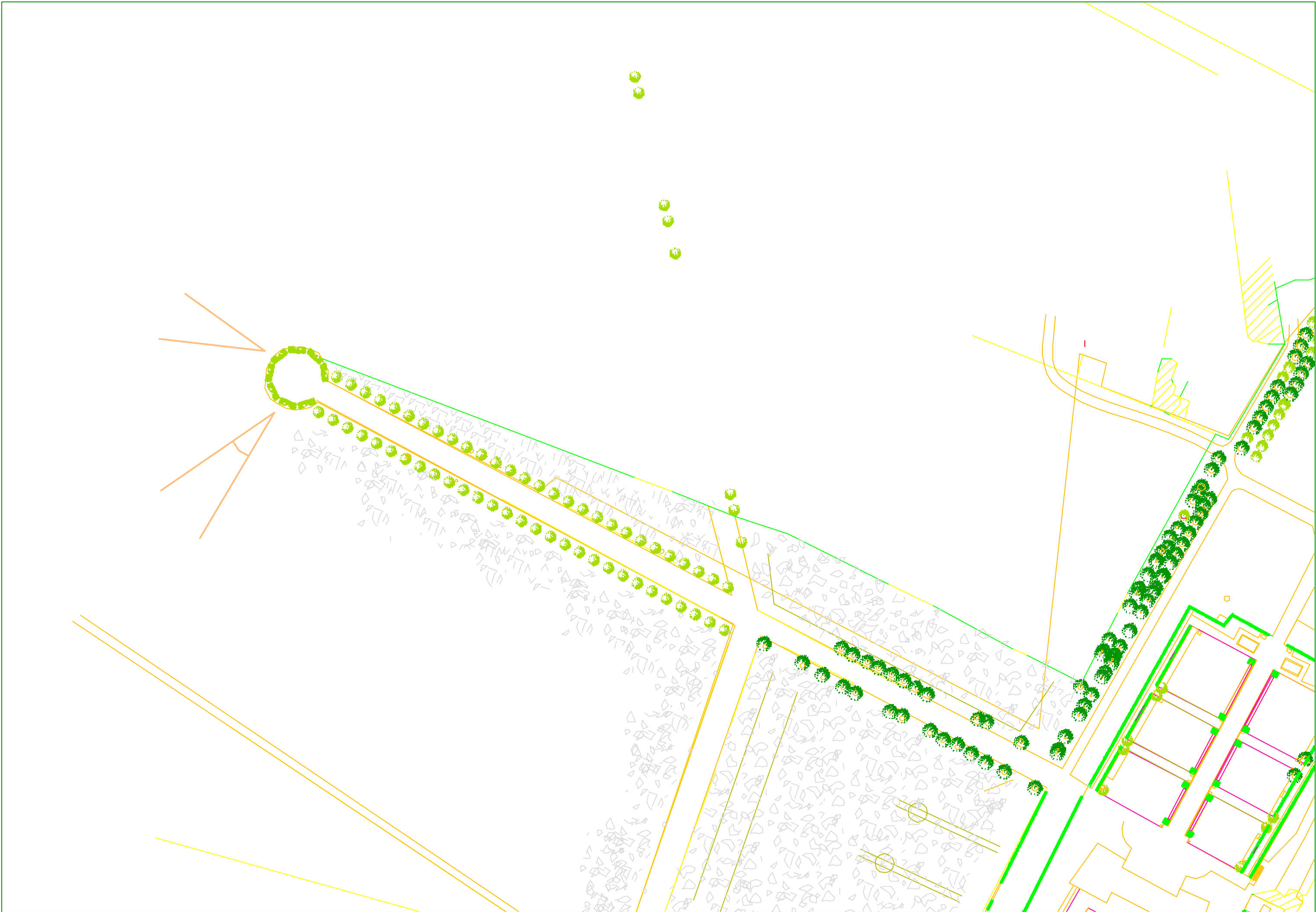

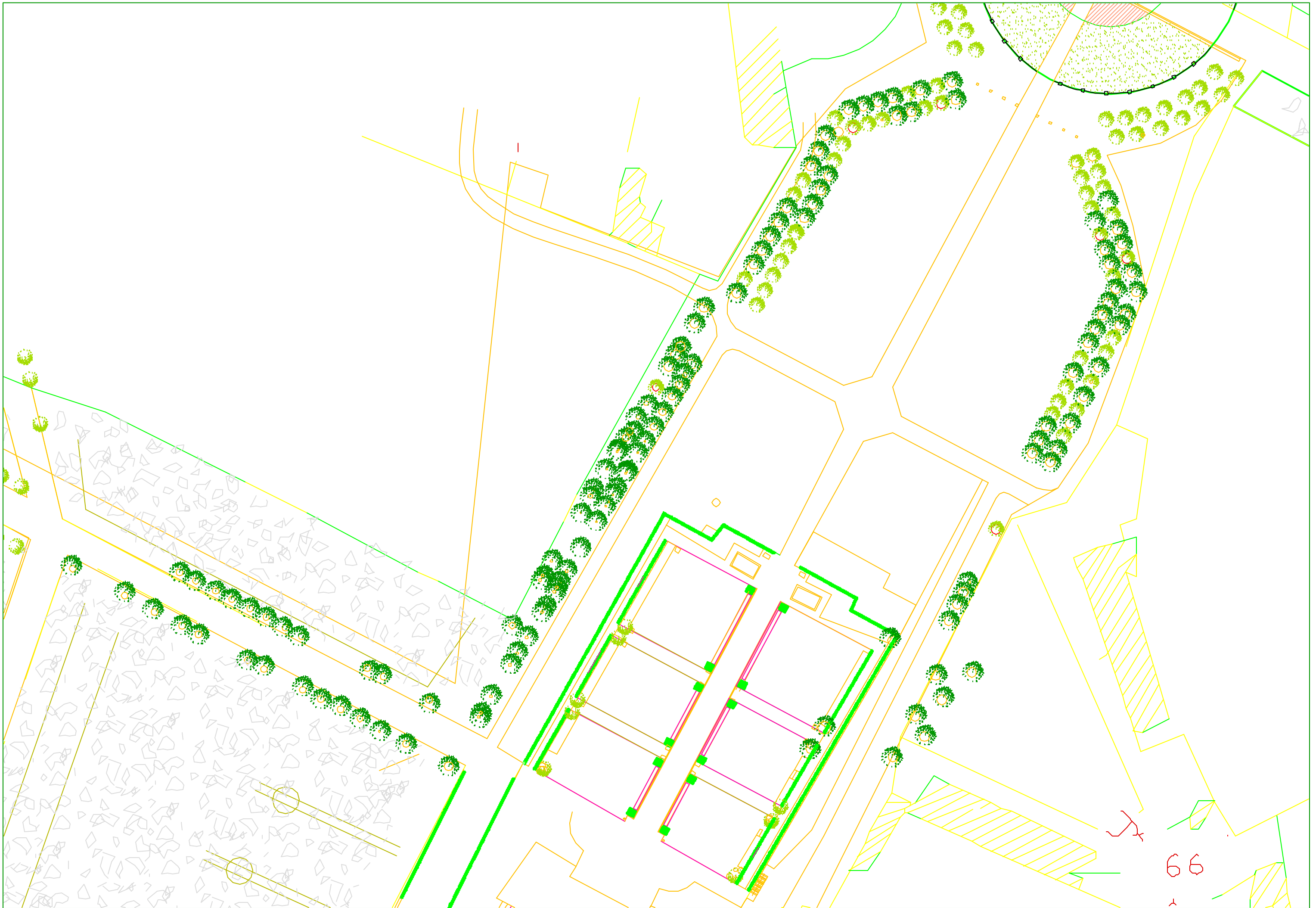

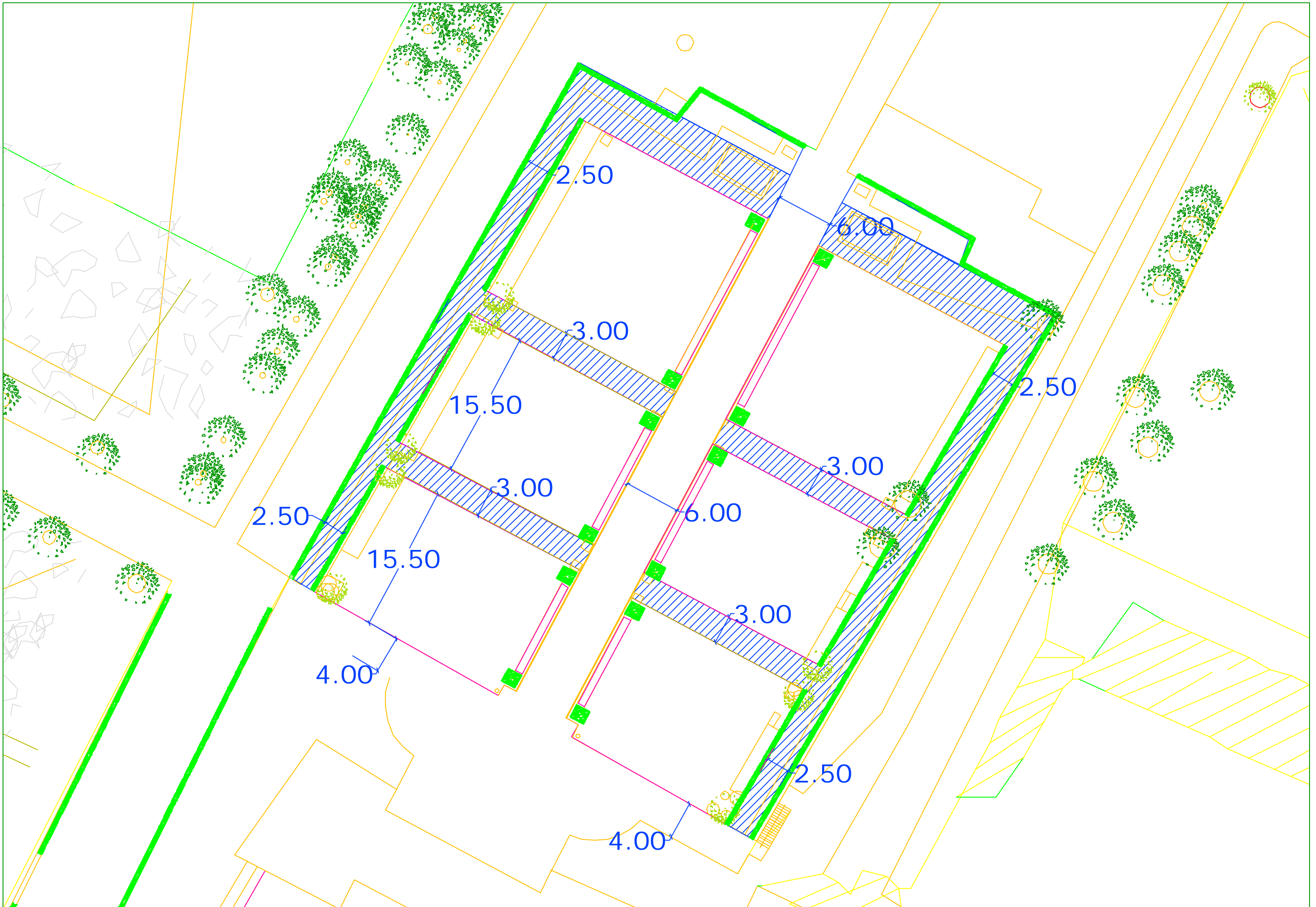

LA MARTINIÈRE

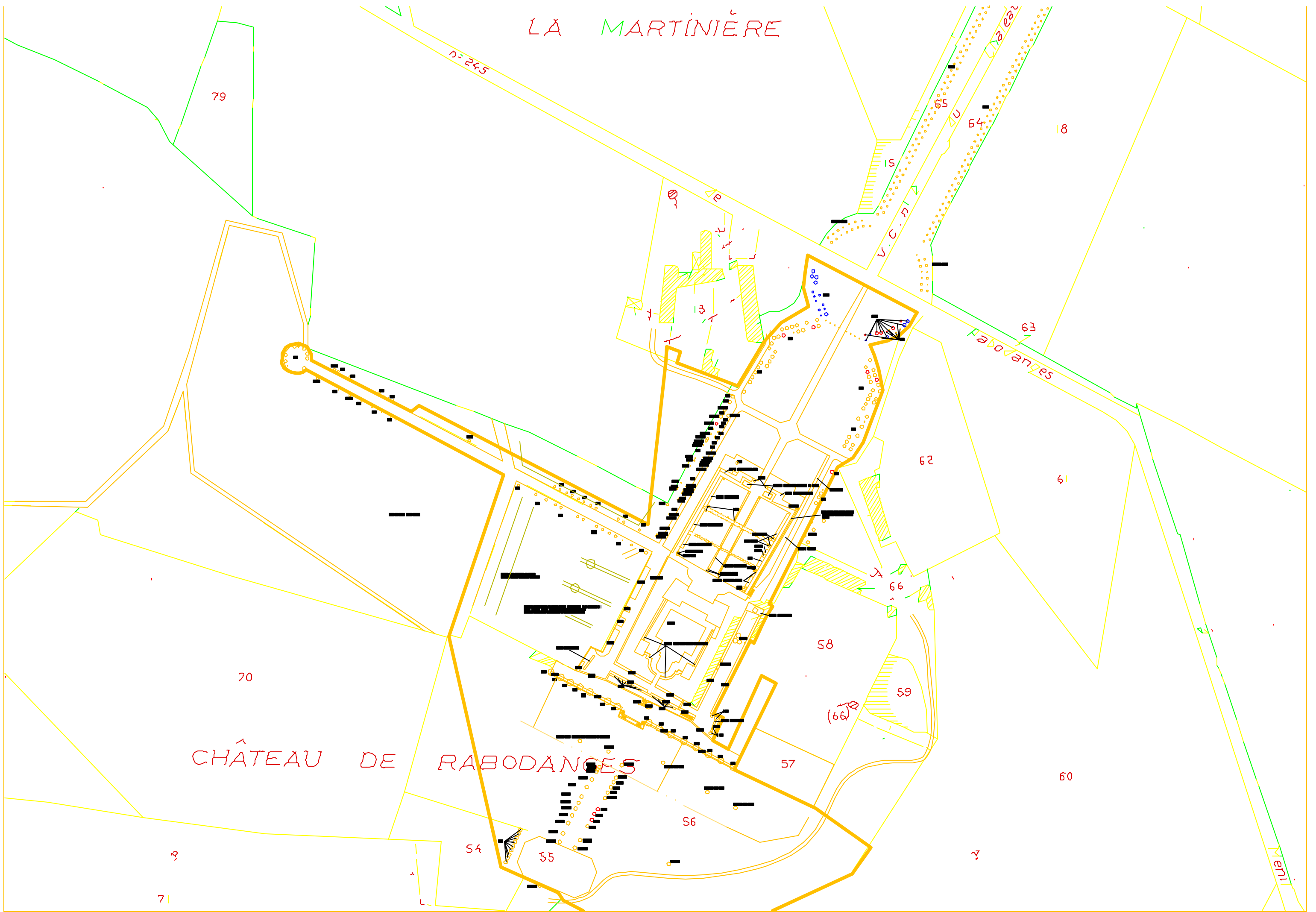

79

D=265

18

62

61

70

58

59

CHÂTEAU DE RABODANGES

57

60

56

54

55

71

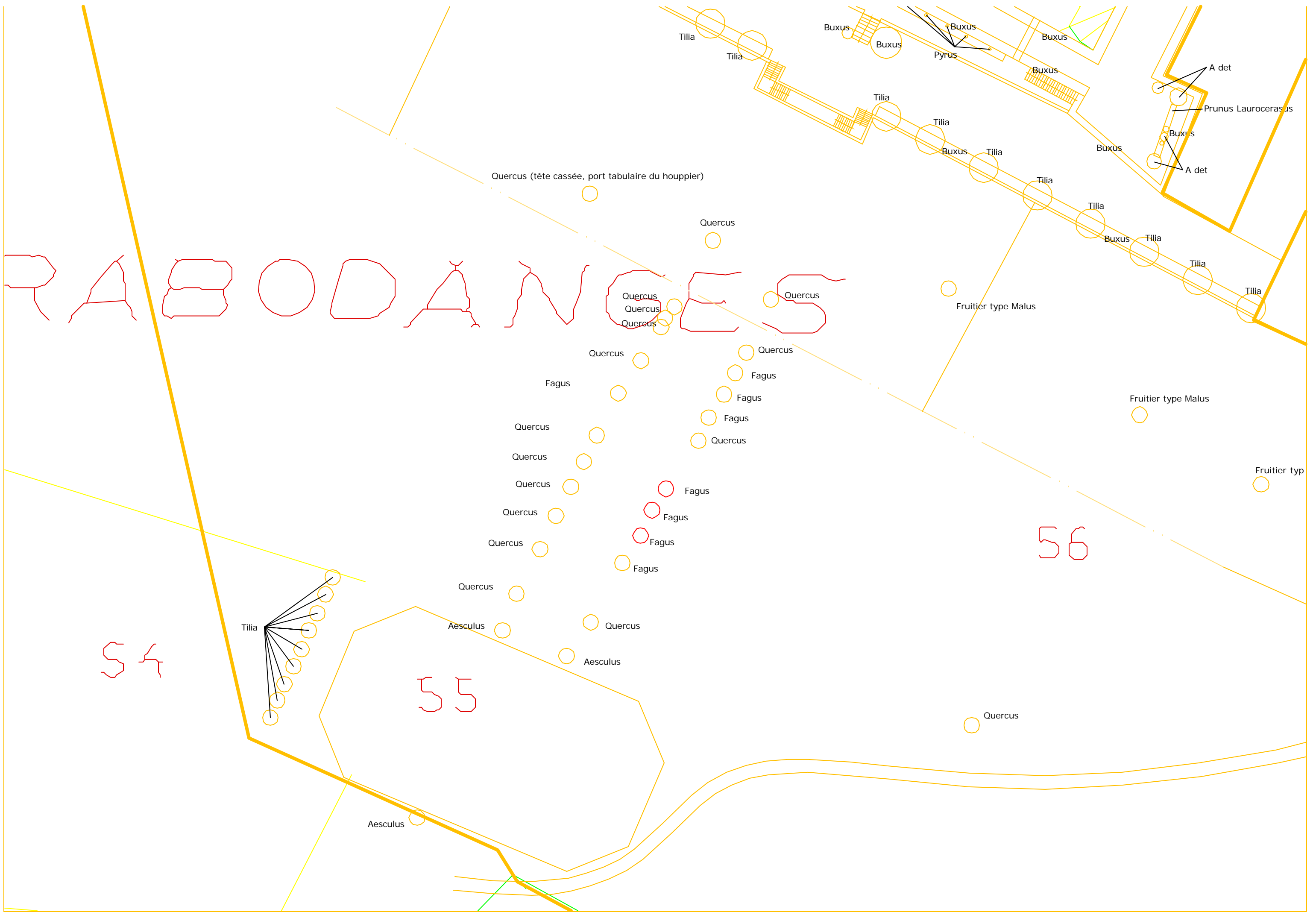

RABODANQUES

54

55

56

Quercus (tête cassée, port tabulaire du houppier)

Tilia

Tilia

Buxus

Buxus

Pyrus

Buxus

Buxus

A det

Prunus Laurocerasus

Buxus

A det

Tilia

Tilia

Buxus

Tilia

Tilia

Tilia

Buxus

Tilia

Tilia

Tilia

Quercus

Quercus

Quercus

Quercus

Quercus

Quercus

Fagus

Fagus

Fagus

Fagus

Quercus

Quercus

Quercus

Quercus

Fagus

Quercus

Fagus

Quercus

Fagus

Quercus

Quercus

Aesculus

Aesculus

Fruitier type Malus

Fruitier type Malus

Fruitier typ

Tilia

Aesculus

Quercus

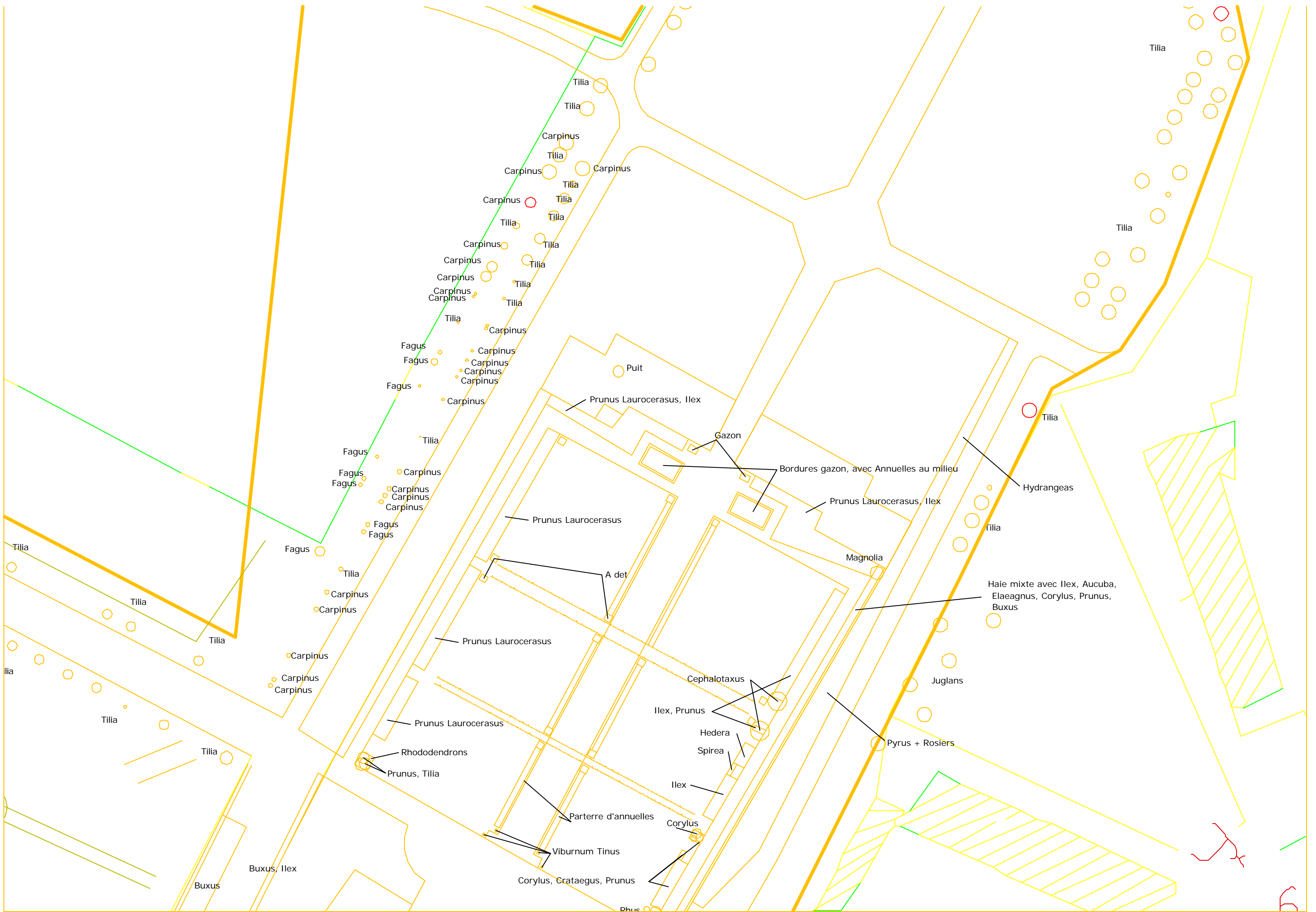

avec beaucoup de Taxus,
Buxus, Aesculus, Fagus...

Présence d'alignement de Taxus, datant certainement de la période de
jardin anglais, Parfois alignement de plus de 10 Taxus...
Quelques groupements circulaires de Taxus...Ronde...

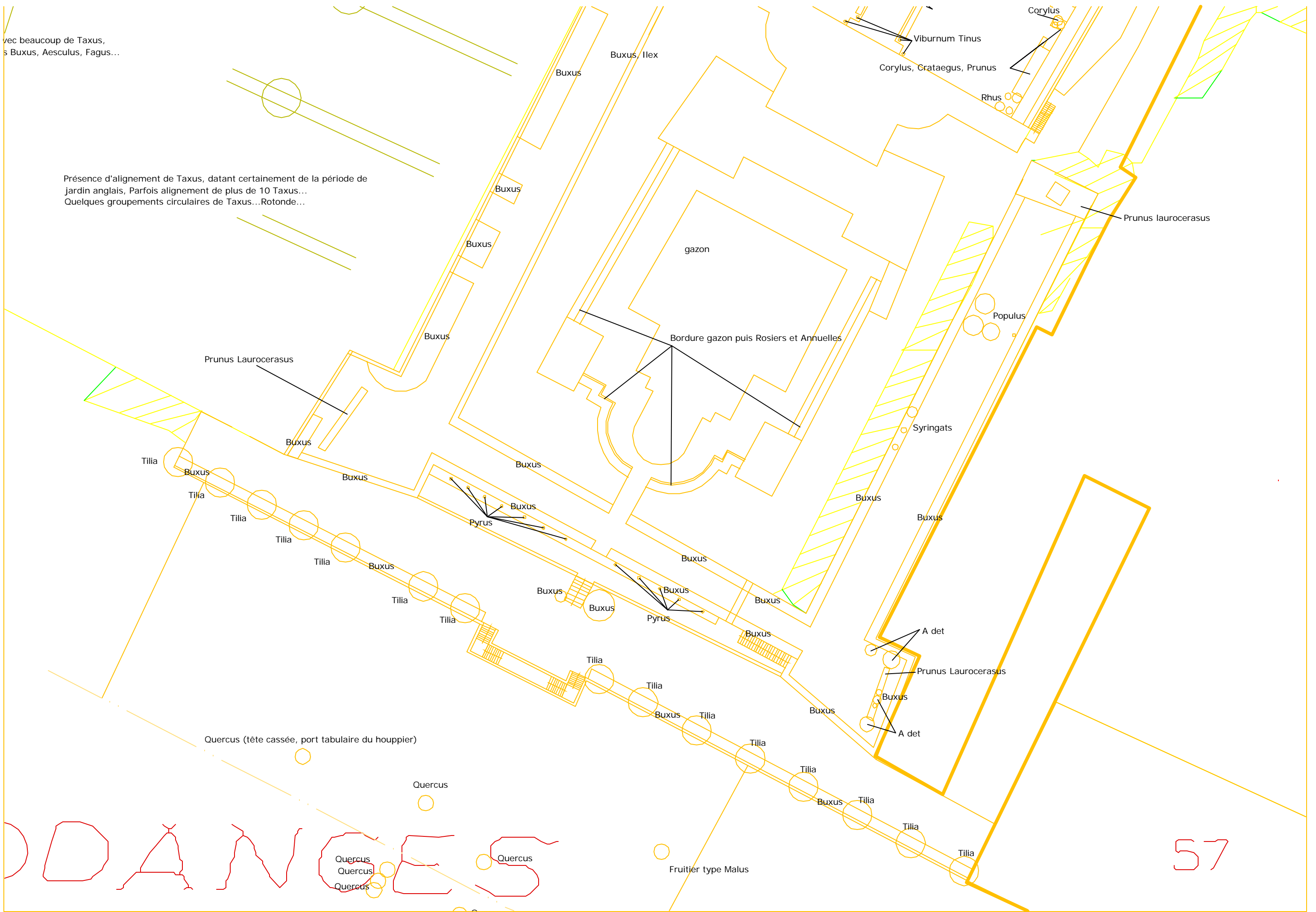

DANES

57

